

Ashtons

7 Pinfold Court Sherburn In Elmet LS25 6LD

£600 PCM

1



1



1



D



A semi detached one bedroom house located in Sherburn in Elmet with off street parking and a garden to the front of the house. The property is offered on an unfurnished basis and comprises; living room and kitchen with built in oven and plumbing for a washing machine on the ground floor with a spiral staircase leading upstairs with one double bedroom and a bathroom.

Available Now

12 Month tenancy / EPC Rating D / Deposit £700 / Council Tax A (Selby council)

GROUND FLOOR
204 sq.ft. (18.9 sq.m.) approx.

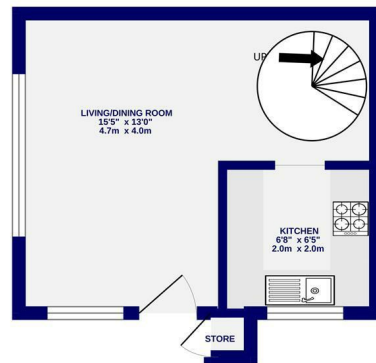

1ST FLOOR
201 sq.ft. (18.6 sq.m.) approx.

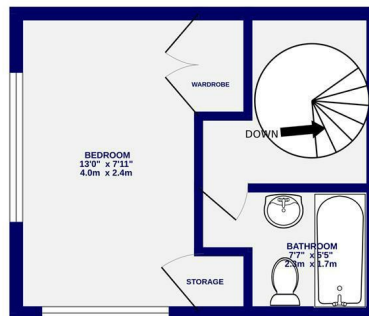

TOTAL FLOOR AREA: 404 sq.ft. (37.6 sq.m.) approx.
Whilst every attempt has been made to ensure the accuracy of the floorplan, measurements of rooms and any other items are approximate. If included in the plan the garage/store will form part of the overall floor area and no responsibility is taken for any error, omission or mis-statement. This plan is for illustrative purposes only and should be used as such by any prospective purchaser. The services, systems and appliances shown have not been tested and no guarantee as to their operability.
Made with Metropix 11/2024



Ashtons Lettings



01904 731404



lettings@ashtonsnet.com

